

Two Way Articulation Probe

User Manual

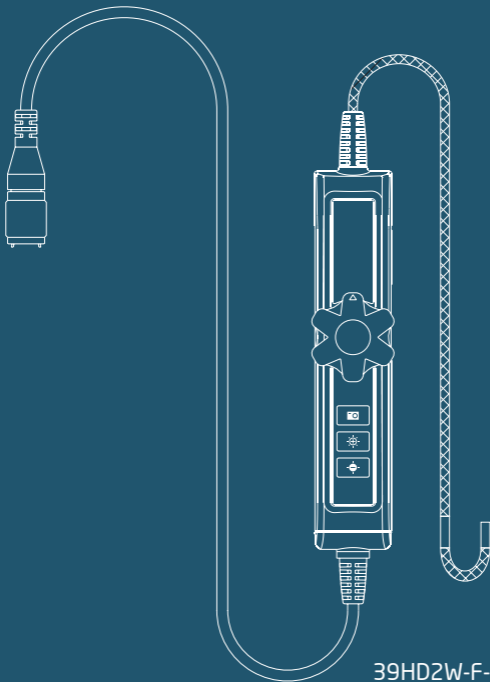

39HD2W-F-1M-SS

Contents

Product Outlook.....	2
Getting Started.....	4
Operations.....	5
Function buttons.....	6
Specifications.....	7
Cautions for use.....	8

Product outlook

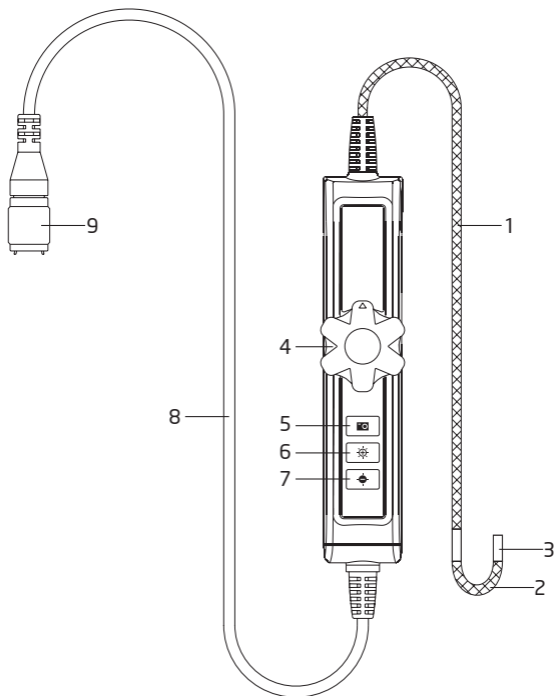

1. **Probe** - To guide camera head to inspection area.
2. **Bending Neck** - To bend camera to change view angle.
3. **Camera Head** - Lighting and image capture.
4. **Control Wheel**- To adjust bending neck angle
5. **Snapshot/ Video button** - Short press for snapshot. Long press for video.
6. **Brightness+ button** - Ideal of extremely dark environment inspections.
7. **Brightness button** - Reduce brightness.
8. **Connecting Cable**
9. **Connector**

Getting started

Step1: Align the dot printed on the probe and the monitor connector.

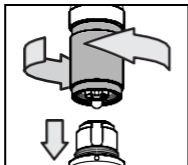

Step2: Carefully plug the probe into the monitor.

Step3: Tighten the connecting collar to secure the probe connection.

* Please turn off the monitor before changing a probe.

Operations

Articulation

Turn the control wheel clockwise to bend the probe neck to the right; turn the control wheel counter-clockwise to bend the neck to the left. The articulation range is 180° maximum, do not attempt to force the control wheel past the bend limit.

Use caution when removing the probe from an inspection area; if the neck is at an angle, it may bind and become difficult to remove.

Straighten the neck before removing the probe from the inspection area.

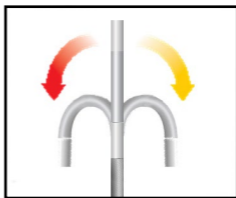
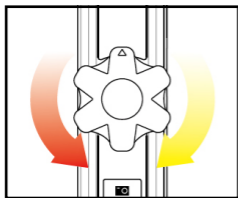

Warning

Do not over-rotate the control wheel. Stop rotating the control wheel when the bending neck reaches its maximum angle.

Do not use excessive force while adjusting bending neck. Damage to the camera probe may result from excessive force or tight winding.

Function buttons

Snapshot button

Short press for snapshot. Long press for video.

Brightness+ button



* live image



* brightness+

Brightness- button



* live image



* brightness-

Specifications

39HD2W-F-1M-SS

Probe head diameter	3.9mm
Probe head length	17mm
Probe length	1m
Articulation angle	right-left 180°(*)
Probe head material	Stainless steel
Probe material	Outer braided stainless steel
Light source	Front LEDs
FOV	90°
DOF	1cm~10cm
Button	Snapshot/Video, brightness+, brightness-
Working temperature	-10°C~60°C
Storage temperature	If the probe is kept for a long time (3 months or more), it is strongly recommended that the probe is preserved at dry and temperature appx. 20°C
Applicable monitor	V8, VF500, VF700

*The maximum articulation angle may degrade due to the bending loops of tube.

Cautions for Use

- To avoid danger, do not put the insert probe into any flammable liquid or gas.
- The insert probe contains a series of small wires that control the optics and electronics of the camera head. To ensure reliability, do not bend the insert probe more than 90°, and always keep the probe a large arc as possible for storage.
- This product is designed for industrial use only. Do not use for human or any other biological inspection.
- Do not use any corrosive liquid for cleaning, such as alcohol.
- Do not try to disassemble the product, it might cause damage or electric shock.
- Please use only recommended components or accessories, unapproved accessories and components may cause damages.
- Avoid direct sun exposure and store the product in a cool, dry and well-ventilated place.
- In order to protect camera module, be sure to have a thread protective ring on the top of camera head if no accessories are used.

Bending neck is composed with precision components, DO NOT put under heavy load on this.

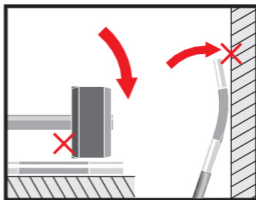

DO NOT rotate the wheel when it is at the maximum angle.

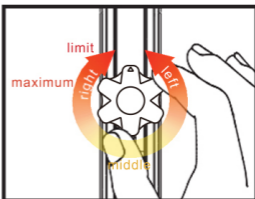

Never use the bending neck as a HOOK.

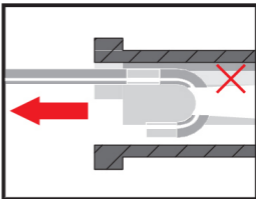

Please straighten the bending neck every time before storage.

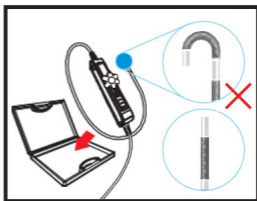

NEVER bend the bending neck with hand, operate by control wheel only.

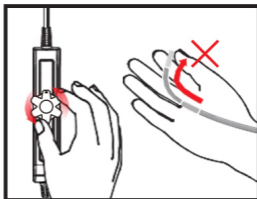

Please keep the probe straight while in use.

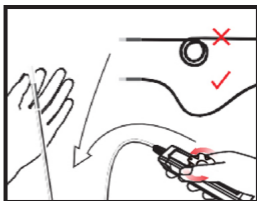

Do not bundle the probe less than a 15cm circle while not in use.

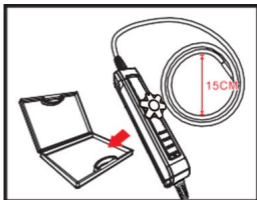

Liquid immersion passed: unleaded gasoline, diesel, machine oil, brake oil, transmission oil, and water.

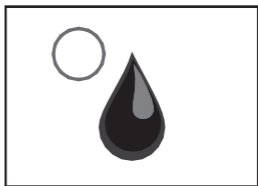

Use cleaning liquid and swab provided in the cleaning kit for camera head cleaning.

